



MACDONALD  
MANCHESTER HOTEL



## THE MANCUNIAN WAY

IT'S NOT FOR NOTHING THAT THE NEW YORK TIMES HAS VOTED MANCHESTER ONE OF THE WORLD'S TOP 20 'MUST SEE' DESTINATIONS.

You'll find one of the UK's best shopping experiences with everything from independent pop-up shops to the world's oldest department store, Europe's third largest Chinatown, two of the world's biggest football clubs and a calendar of internationally acclaimed events which includes the Manchester International and the Manchester Jazz Festival. The M.E.N.Arena – the third busiest music venue on the planet – continues

to draw the biggest acts to the North West, whilst its nightlife needs no introductions.

So it may well be business that brings you to Manchester, but there's plenty to entice you back for a weekend less ordinary.

*Above image by: Marketing Manchester*



## MACDONALD MANCHESTER

THE MACDONALD MANCHESTER OCCUPIES A LANDMARK BUILDING ON LONDON ROAD. IT'S A BUILDING WITH AN UNEXPECTED PAST, FOR WHILST MOST MANCUNIAN WILL REMEMBER IT AS THE FORMER TELEPHONE EXCHANGE, FEW WILL KNOW IT WAS ORIGINALLY INTENDED TO BE THE CITY'S MOST LUXURIOUS AND AVANT GARDE HOTEL.

However, history was to take a slightly different turn and it would be a further 25 years before the first guests checked in, following a £50 million investment by Macdonald Hotels.

Behind its alluringly curved façade you'll find 338 of the city's biggest bedrooms, 14 meeting rooms, award winning dining and a spa that's one of the city's best kept secrets.



## 338 OF THE CITY'S LARGEST & BEST BEDROOMS

THE FIRST THING YOU'LL NOTICE ABOUT YOUR BEDROOM AT THE MACDONALD MANCHESTER IS THE SENSE OF LIGHT AND SPACE. THAT'S IF YOU'RE NOT DISTRACTED BY YOUR PERSONAL BOSE IPOD DOCKING STATION, THE ENORMOUS KING SIZE BED OR THE MESMERISING VIEW FROM YOUR WALL TO WALL WINDOW.

Little touches such as complimentary high speed broadband, flat screen televisions with more than 80 channels and spacious, stylish bathrooms make them amongst the best appointed. They're also reassuringly practical with plenty of desk space, a laptop safe, individual air conditioning, lots of storage and steam irons.

Spoil yourself and upgrade to a City View or Panoramic Room and enjoy the vista across the Manchester skyline (great by night, we might add), even more space and a guaranteed separate walk in shower.

So if you need a quiet space to work, a base for a night out on the town or a romantic weekend away, there's a bedroom just for you at the Macdonald Manchester.



## FIRST CLASS MEETINGS & EVENTS

BLUE SKY THINKING. ENGAGING DEVELOPMENT. THE WINNING PITCH.

**Whichever result you're seeking from your event, Macdonald Manchester offers the space, the facilities and the service to help you realise it.**

- Twelve meeting rooms for up to 70 delegates
- All rooms situated together on one dedicated floor; with breakout areas
- Each room air conditioned with natural daylight throughout
- Integrated plasma or drop down screens with ceiling mounted LCD projection
- Smart AV control panels, dimmer lighting & hearing induction loops

What more could you ask for?

Well, for larger events including private dining, the Piccadilly Suite has the space for up to 240 people and can be divided into two. It's a flexible space with its own facilities, bar and fabulous views. A real talking point.

The Meetings @ Macdonald package means you'll have a dedicated point of contact throughout the day, and the choice of a working finger buffet or a creative, fresh deli lunch in the restaurant. Three refreshment breaks a day keeps you working, and the complimentary high speed broadband keep you working fast.

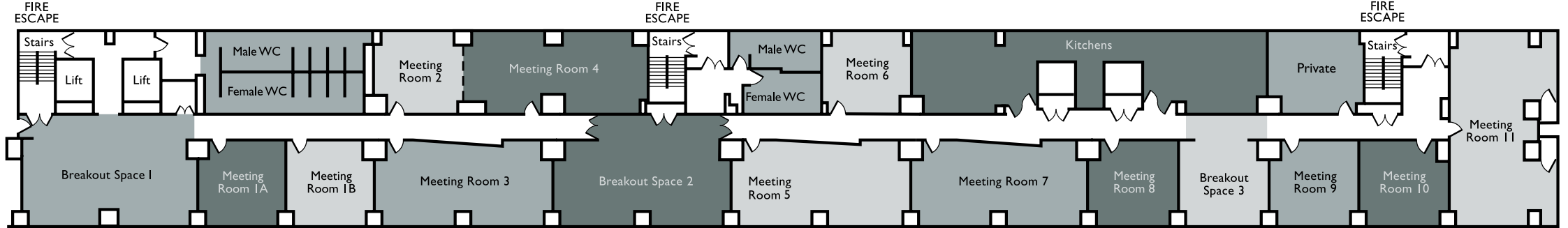

CONFERENCE CORRIDOR FLOORPLAN



## MACDONALD'S UNIQUE APPROACH TO HOSPITALITY

THE MACDONALD MANCHESTER IS AN ACCREDITED MEMBER OF THE MEETINGS INDUSTRY ASSOCIATION, WHICH IN A NUTSHELL MEANS THAT WE DELIVER EVENTS AT A CONSISTENTLY HIGH STANDARD, IN LINE WITH THE ASSOCIATION'S GUIDELINES.

Couple this with Macdonald's unique approach to hospitality, and whether you're organising a small training seminar, an awards dinner or large conference, you can be reassured that our team will deliver it just as you planned it.



	ROOM CAPACITIES								ROOM DIMENSIONS		DOOR DIMENSIONS				
	THEATRE - FP	THEATRE - RP	BOARDROOM	CABARET - FP	CABARET - RP	CLASSROOM	U-SHAPE	BANQUET	LENGTH (M)	WIDTH (M)	HEIGHT (M)	WIDTH (M)	NATURAL LIGHT	AIR CON.	FLOOR NO.
Piccadilly Suite	240	180	-	120	90	90	-	250	23	11.2	2.04	1.35	✓	✓	M
Function Room 1	120	120	40	60	50	70	70	120	11.5	11.2	2.04	1.35	✓	✓	M
Function Room 2	120	120	40	60	50	70	70	120	11.5	11.2	2.04	1.35	✓	✓	M
Meeting Room 1A	20	-	12	8	-	12	12	12	5.6	5.6	2.04	0.92	✓	✓	1
Meeting Room 1B	20	-	12	8	-	12	12	12	5.8	5.6	2.04	0.92	✓	✓	1
Meeting Room 2	20	-	12	8	-	12	12	12	6	5.6	2.04	0.92	✓	✓	1
Meeting Room 3	50	-	28	28	-	29	25	30	11.4	5.6	2.04	0.92	✓	✓	1
Meeting Room 4	50	-	28	28	-	30	21	40	11.5	5.6	2.04	0.92	✓	✓	1
Meeting Rooms 2 & 4	70	-	32	40	-	40	32	50	17.5	5.6	2.04	0.92	✓	✓	1
Meeting Room 5	50	-	28	28	-	29	25	30	11.4	5.6	2.04	0.92	✓	✓	1
Meeting Room 6	20	-	12	8	-	12	12	12	5.8	5.6	2.04	0.92	✓	✓	1
Meeting Room 7	50	-	28	28	-	29	25	30	11.4	5.6	2.04	0.92	✓	✓	1
Meeting Room 8	20	-	12	8	-	12	12	12	5.8	5.6	2.04	0.92	✓	✓	1
Meeting Room 9	20	-	12	8	-	12	12	12	5.8	5.6	2.04	0.92	✓	✓	1
Meeting Room 10	20	-	12	8	-	12	12	12	5.8	5.6	2.04	0.92	✓	✓	1
Meeting Room 11	70	-	30	40	-	30	30	50	12.8	7.25	2.04	0.92	✓	✓	1

FP = Front projection RP = Rear projection LG = Lower ground G = Ground M = Mezzanine 1 = First 2 = Second 3 = Third 4 = Fourth



## WELLBEING

WE KNOW LIFE CAN THROW A LOT AT YOU.

But escape to the Macdonald Manchester Spa and you'll find yourself a million miles from the hustle of the city centre. Taking its inspiration from the Orient, it's the city's ultimate urban retreat. A peaceful space that defies its location, where you'll find six luxuriously appointed treatment rooms, a blissfully peaceful chill out den and a team of highly experienced experts ready to induce you into a state of sheer relaxation.

An extensive range of Decl or products and two Jessica nail bars will leave you feeling refreshed and ready to face the world.

Guests of the spa and hotel also have complimentary access to the Thermal Suite which includes six individual experiences; traditional Scandinavian rock sauna, eucalyptus scented steam room, infra red sauna, ice igloo, heated loungers and experience shower.

Fitness junkies will appreciate the gym, with a suite of more than 15 cardiovascular, resistance and core Technogym™ stations that are freely available for all guests.



## FOOD & DRINK



IF HOTEL RESTAURANTS AREN'T YOUR THING, THINK AGAIN . WE'VE WON OUR THIRD CONSECUTIVE AA ROSETTE, AND ITS THANKS NOT JUST TO OUR YOUNG, COMMITTED BRIGADE OF CHEFS BUT ALSO THE HARDWORKING HIGHLAND FARMERS AND HARDY FISHERMEN WHO BRACE THE SCOTTISH WATERS DAILY TO KEEP OUR KITCHENS STOCKED AND OUR DISHES FRESH.

**Macdonald Hotels are committed to Simply Fresh Food, and when we say we use the finest ingredients, it's no tired old clich . All our salmon is sourced from John Ross Jnr, our pork is outdoor reared on Lincolnshire and Norfolk farms and our chickens are corn fed and free range.**

You'll taste this commitment to sourcing the very best in our breakfasts, our conference lunches or over a leisurely dinner in Signatures Restaurant, where the seasonally changing   la carte menu, the freshly sourced Market Menu which changes fortnightly and separate grill menu guarantee the regular visitor will never tire of choice.



#### DIRECTIONS

RAIL | Manchester Piccadilly Station is adjacent to the hotel | Exit by Fairfield Street.  
AIR | Manchester Airport is 13 miles away | Full directions & maps are available on our website.

#### GDS ACCESS CODES

Amadeus MANMAC | Sabre 12628 | Gallileo 48862 | Worldspan 088

**Macdonald Manchester Hotel & Spa** London Road, Manchester, M1 2PG

Tel 0844 879 9088 Fax 0870 194 2237

**[www.MacdonaldHotels.co.uk/Manchester](http://www.MacdonaldHotels.co.uk/Manchester)**