

MACDONALD
TICKLED TROUT HOTEL
 PRESTON



THE WELL APPOINTED MACDONALD TICKLED TROUT HOTEL IS CONVENIENTLY LOCATED JUST OFF THE M6. THIS VENUE'S NEW CONFERENCE CENTRE IS ONE OF THE FINEST IN THE NORTH WEST, THE SERVICE HERE IS SECOND TO NONE, AND THE HOTEL HAS THE FINEST COUNTRYSIDE OF FOUR COUNTIES ON ITS DOORSTEP.

CONFERENCES AND EVENTS

A wide choice of state-of-the art boardrooms and business suites provide the flexibility for events ranging from small board meetings to large receptions or banquets.

CAR PARKING: 200 complimentary

ACCOMMODATION

Offering 98 en-suite spacious bedrooms, including four junior suites and 68 superior bedrooms. Most have stunning views over the river:

DINING AND ENTERTAINMENT

The Restaurant serves a fantastic choice of traditional and international dishes, complemented by an extensive wine list. In the relaxing lounge you can also enjoy a light meal or refreshment.

FOR YOUR INTEREST

- Samlesbury Hall
- Wigan Pier
- Camelot Theme Park
- Astley Hall
- Botany Bay
- Blackpool Illuminations & Pleasure Beach
- Martin Mere
- Houghton Tower
- Racing at Haydock
- Liverpool Cathedral
- Manchester Cathedral

HOW TO GET THERE

Rail: Preston 2 miles
Air: Blackpool Airport 20 miles
 Manchester Airport 40 miles
 Liverpool Airport 45 miles
Road: M6 exit J31
 For directions please visit www.MacdonaldHotels.co.uk/TickledTrout

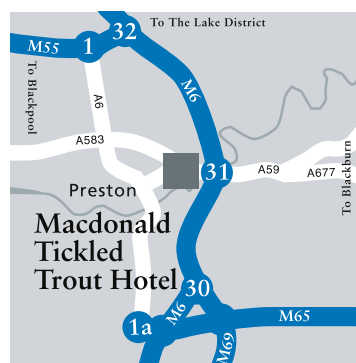



CONFERENCE DIRECT
 0845 604 4242

Preston New Road
Samlesbury
Preston
Lancashire PR5 0UJ
 T 0844 879 9053
 F 01772 877 463
 E events.tickledtrout@macdonald-hotels.co.uk

LAKES & THE NORTH

MACDONALD
TICKLED TROUT HOTEL
NR PRESTON

KEY

-  DOUBLE POWER SOCKET
-  SINGLE POWER SOCKET
-  TV AERIAL SOCKET
-  ISDN SOCKET
-  SMART BOARD
-  TELEPHONE SOCKET
-  MOVEABLE PARTITION
-  VIDEO SCREEN
-  TEMP/AIRCON CONTROL
-  PA SYSTEM SOCKET
-  LIGHT SWITCH/DIMMER
-  ADSL SOCKET
-  FAX SOCKET
-  WIRELESS BROADBAND

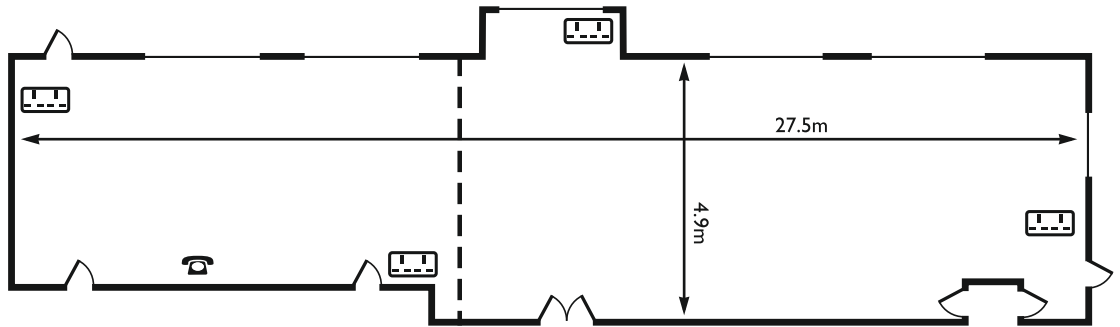

THE RIBBLE

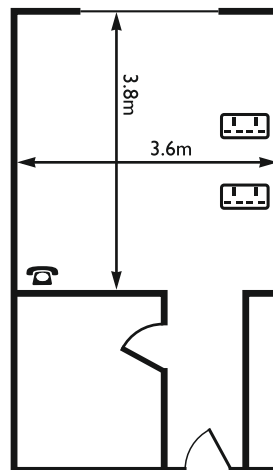

SYNDICATE ROOMS
100, 102, 104 AND 106

	ROOM CAPACITIES								ROOM DIMENSIONS		DOOR DIMENSIONS				
	THEATRE - FP	THEATRE - RP	BOARDROOM	CABARET - FP	CABARET - RP	CLASSROOM	U-SHAPE	BANQUET	LENGTH (m)	WIDTH (m)	HEIGHT (m)	WIDTH (m)	NATURAL LIGHT	AIR CON.	FLOOR NO.
The Ribble	120	-	50	60	-	65	45	80	27.5	4.9	2.22	0.82	✓		G
Syndicate Rooms (4)	-	-	7	-	-	-	-	-	6.2	3.6	1.75	0.75	✓		G
River Room 1	60	-	35	40	-	45	28	50	13.6	10.8	2.22	0.82	✓		G
River Room 2	80	-	40	60	-	50	35	65	17.5	5.8	2.2	0.72	✓	✓	G
River Room 3	40	-	20	25	-	25	22	20	10.4	4.7	2.36	0.82	✓	✓	G
Boardroom 1	40	-	24	25	-	25	20	30	8	7	2.22	0.82	✓	✓	G
Boardroom 2	-	-	8	-	-	-	-	-	4.8	3.8	2.22	0.82	✓	✓	G
Boardroom 3	-	-	16	-	-	-	-	-	7.4	4.7	2.22	0.91	✓	✓	G
Boardroom 4	-	-	14	-	-	-	-	-	7.0	5.5	2.22	0.91	✓	✓	G
Boardroom 5	-	-	16	-	-	-	-	-	7.4	6	2.22	0.82	✓	✓	G
Boardroom 6	-	-	14	-	-	-	-	-	7	5.5	2.22	0.82	✓	✓	G

FP = Front projection RP = Rear projection LG = Lower ground G = Ground 1 = First 2 = Second 3 = Third 4 = Fourth

MACDONALD
TICKLED TROUT HOTEL
 NR PRESTON

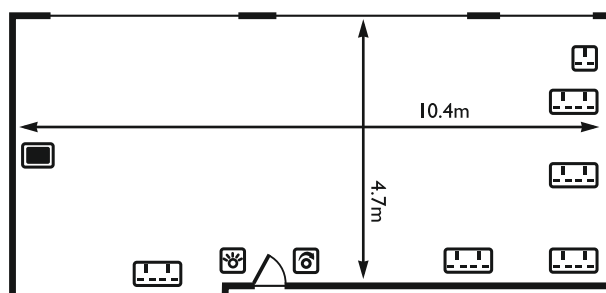
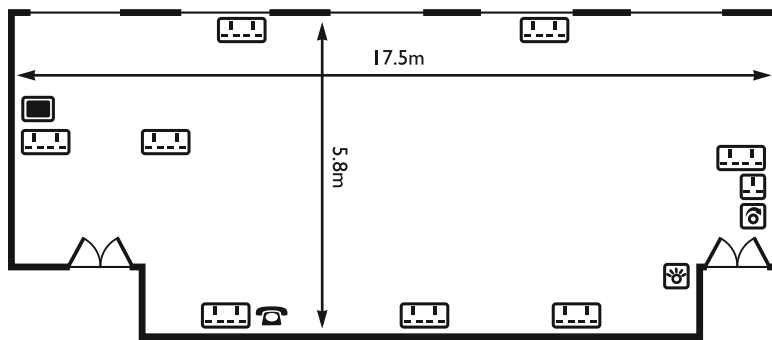
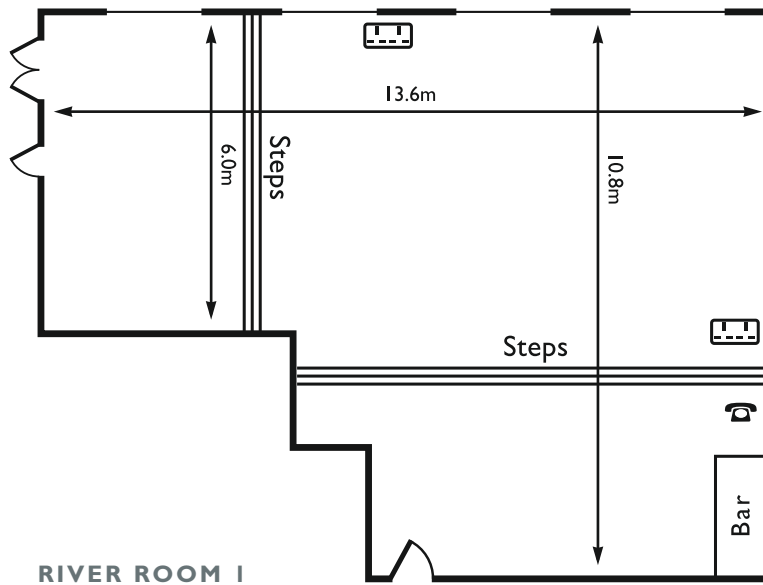















KEY

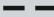

LAKES & THE NORTH

MACDONALD
TICKLED TROUT HOTEL
 NR PRESTON

KEY

- 
DOUBLE POWER SOCKET
- 
SINGLE POWER SOCKET
- 
TV AERIAL SOCKET
- 
ISDN SOCKET
- 
SMART BOARD
- 
TELEPHONE SOCKET
- 
MOVEABLE PARTITION
- 
VIDEO SCREEN
- 
TEMP/AIRCON CONTROL
- 
PA SYSTEM SOCKET
- 
LIGHT SWITCH/DIMMER
- 
ADSL SOCKET
- 
FAX SOCKET
- 
WIRELESS BROADBAND

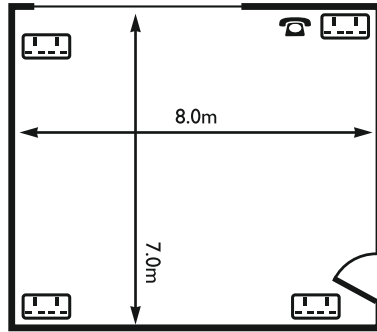

BOARDROOM 1

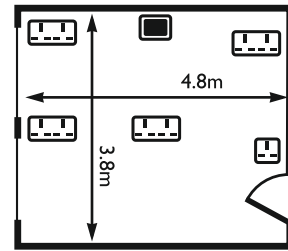

BOARDROOM 2

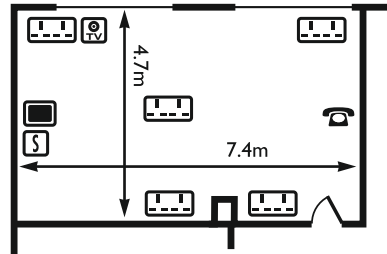

BOARDROOM 3

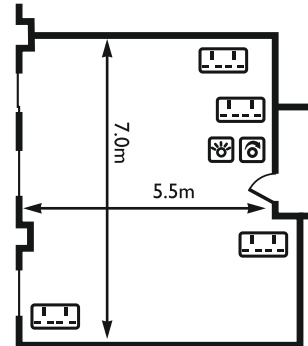

BOARDROOM 4

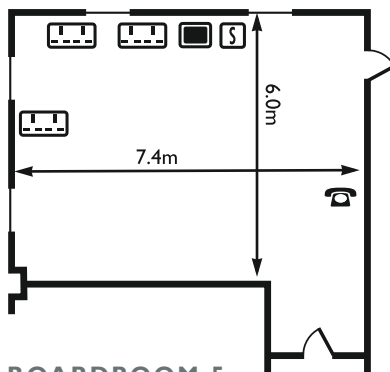

BOARDROOM 5

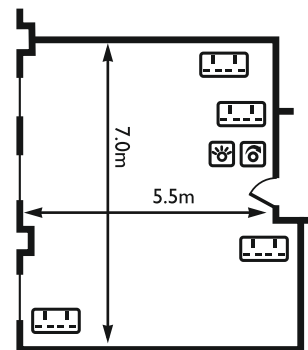

BOARDROOM 6