

SAVILL COURT

HOTEL & SPA – NR WINDSOR

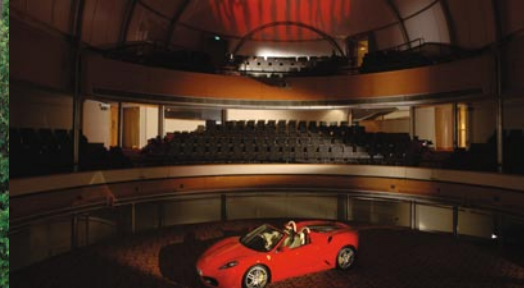

SET IN 22 ACRES OF MANICURED GROUNDS ON THE EDGE OF WINDSOR GREAT PARK, THE NEWLY REFURBISHED JACOBEOAN SAVILL COURT HOTEL & SPA IS AN ELEGANT RETREAT. BOASTING EVERY FACILITY REQUIRED BY THE EVENTS ORGANISER, WE CAN CATER TO ALL YOUR BUSINESS NEEDS.

CONFERENCES AND EVENTS

The Great Hall is the stunning centrepiece of the hotel's conference facilities and plays host to up to 800 delegates. This galleried auditorium on three levels has a domed conservatory roof and a circular floor which can be raised to create two separate halls. Smaller conference rooms for private gatherings include the oak panelled Library and the airy Terrace Room overlooking the garden.

CAR PARKING:

Over 400 complimentary

ACCOMMODATION

We have 140 bedrooms, all of which have been thoughtfully and tastefully refurbished and provide a high level of comfort.

DINING AND ENTERTAINMENT

The renowned Orchid Restaurant draws diners from near and far and serves exquisitely presented classic dishes using only the finest ingredients. A contemporary design with views overlooking our terrace and gardens is perfect for a romantic dinner for two or a privately held larger function.

RECREATION AND LEISURE

Our leisure facility is the jewel in our crown, featuring a stunning 15 metre pool enhanced with Jacuzzi, steam room and sauna, creating a haven of calm and tranquillity. The gym, with both free weights and cardiovascular equipment, is ideal for working off the stresses of the day, but if massage and spa treatments are more to your liking, then our team of trained therapists are on hand. There are three treatment rooms to pamper yourself with, offering an array of treatments including Decl or massage, nail bar treatments and hot stone massage.

FOR YOUR INTEREST

The hotel is ideally placed if you're going to Windsor Castle, Henley Regatta, Royal Ascot, Windsor Races or racing at Kempton Park. Families won't have to go far to enjoy a great day out. Thorpe Theme Park and Lego Land Windsor are both 20 minutes drive from the hotel.

HOW TO GET THERE

Rail: Egham 1 mile

Air: Heathrow Airport 7 miles

Gatwick Airport 40 miles

Road: Just off A30 in the outskirts of Egham

For directions please visit www.MacdonaldHotels.co.uk/SavillCourt



spa
HARMONY AND SERENITY

CONFERENCE DIRECT
0845 604 4242

Bishopsgate
Windsor Great Park
Surrey
TW20 0XN
T 0844 879 9067
F 01784 472 100
E events.savillcourt@macdonald-hotels.co.uk

MIDLANDS & THE SOUTH

SAVILL COURT

HOTEL & SPA – NR WINDSOR

KEY



DOUBLE
POWER SOCKET



SINGLE
POWER SOCKET



TV AERIAL
SOCKET



ISDN SOCKET



SMART BOARD



TELEPHONE SOCKET



MOVEABLE PARTITION



VIDEO SCREEN



TEMP/AIRCON
CONTROL



PA SYSTEM
SOCKET



LIGHT
SWITCH/DIMMER



ADSL SOCKET



FAX SOCKET



WIRELESS BROADBAND

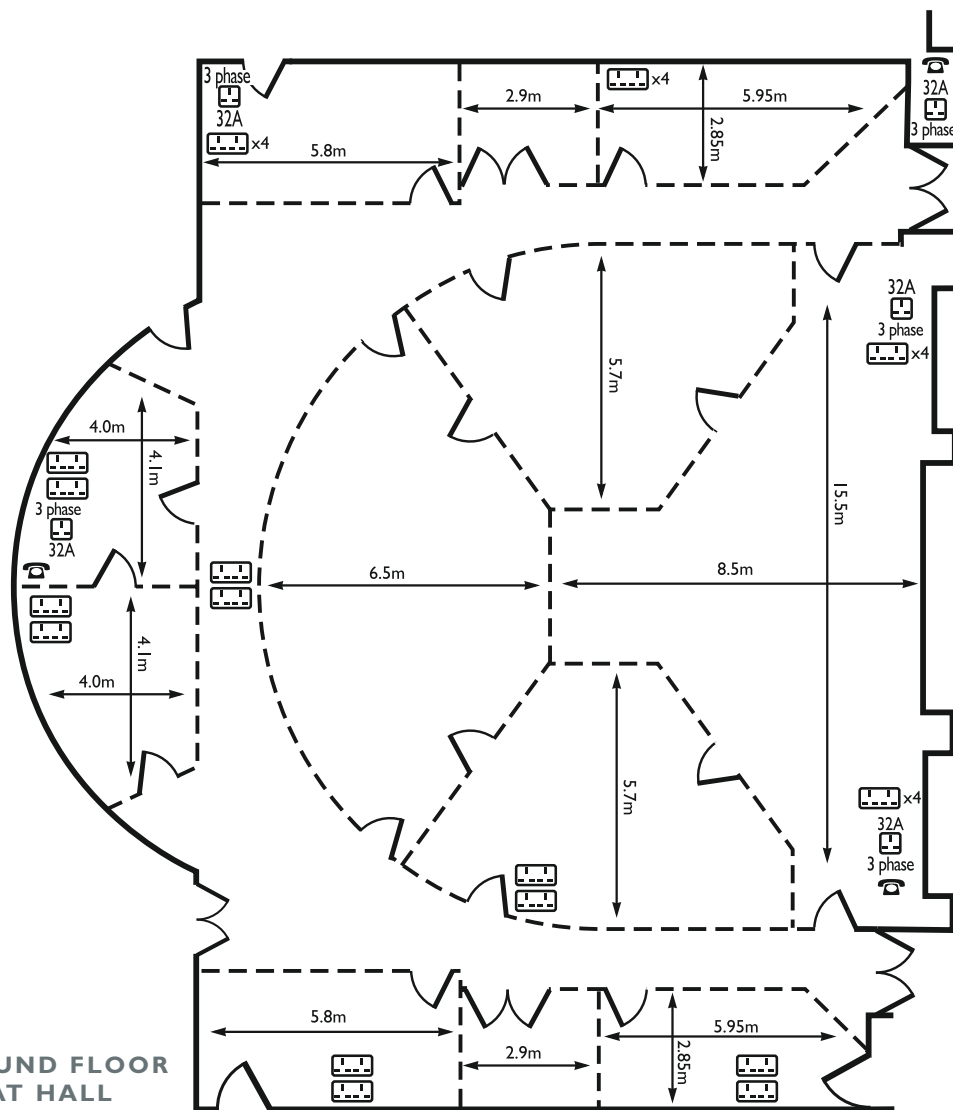

	ROOM CAPACITIES								ROOM DIMENSIONS		DOOR DIMENSIONS				
	THEATRE - FP	THEATRE - RP	BOARDROOM	CABARET - FP	CABARET - RP	CLASSROOM	U-SHAPE	BANQUET	LENGTH (m)	WIDTH (m)	HEIGHT (m)	WIDTH (m)	NATURAL LIGHT	AIR CON.	FLOOR NO.
Great Hall	800	-	80	270	-	175	40	350	20.51	23.81	2.05	2.57	✓	✓	G/1/2/3
Great Hall - Lower	400	-	80	270	-	175	90	350	20.51	23.81	2.20	1.68	✓	✓	G
Great Hall - Upper	400	-	46	70	-	70	40	-	398 sq mtrs		2	2.08	✓	✓	2/3
Orangery	185	-	50	100	-	100	35	220	23.5	13	2	1.8	✓	✓	G
Boardroom 1	-	-	10	-	-	-	-	-	5.6	3.1	1.98	0.90	✓	✓	G
Boardroom 2	20	-	16	16	-	16	-	-	7.9	2.8	1.98	0.90	✓	✓	G
Library	70	-	26	36	-	32	20	50	8.8	7.7	2.26	1.50	✓	✓	G
Terrace	60	-	26	35	-	32	26	50	12	6.5	2.05	1.08	✓	✓	G

FP = Front projection RP = Rear projection LG = Lower ground G = Ground 1 = First 2 = Second 3 = Third 4 = Fourth

SAVILL COURT

HOTEL & SPA – NR WINDSOR

KEY



DOUBLE
POWER SOCKET



SINGLE
POWER SOCKET



TV AERIAL
SOCKET



ISDN SOCKET



SMART BOARD



TELEPHONE SOCKET



MOVEABLE PARTITION



VIDEO SCREEN



TEMP/AIRCON
CONTROL



PA SYSTEM
SOCKET



LIGHT
SWITCH/DIMMER



ADSL SOCKET



FAX SOCKET



WIRELESS BROADBAND

MIDLANDS &
THE SOUTH

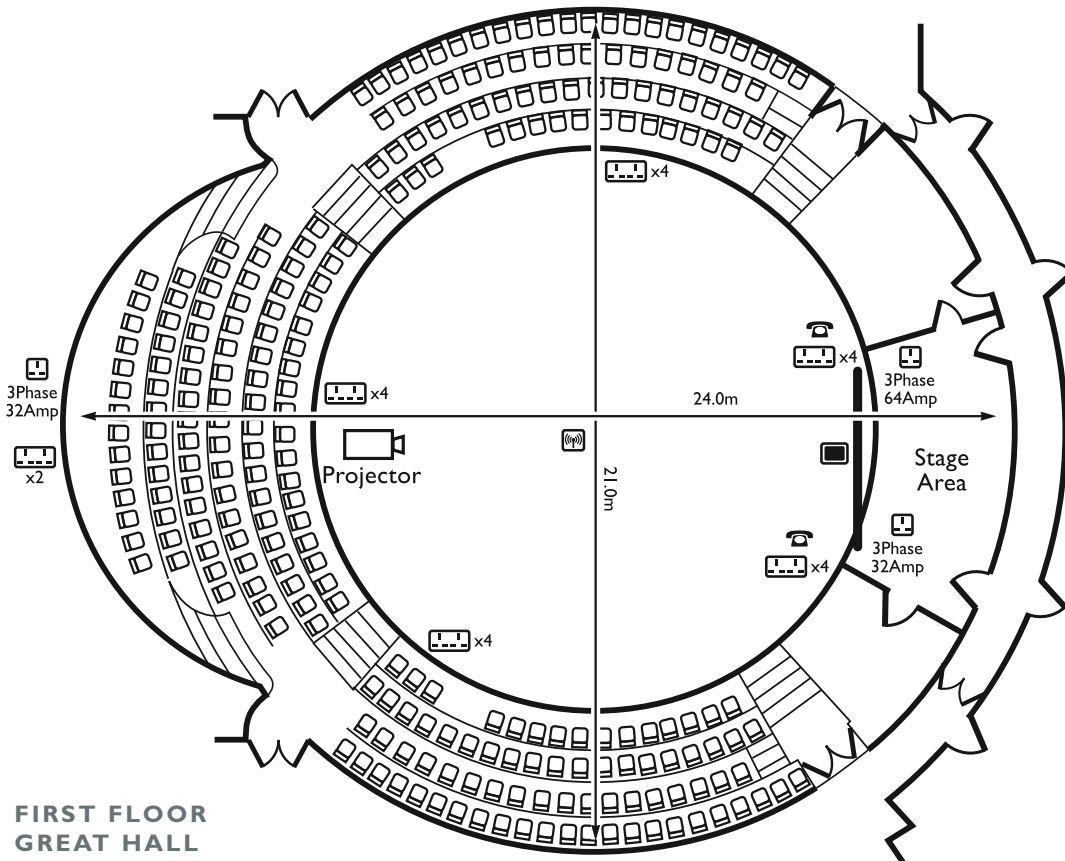

FIRST FLOOR
GREAT HALL

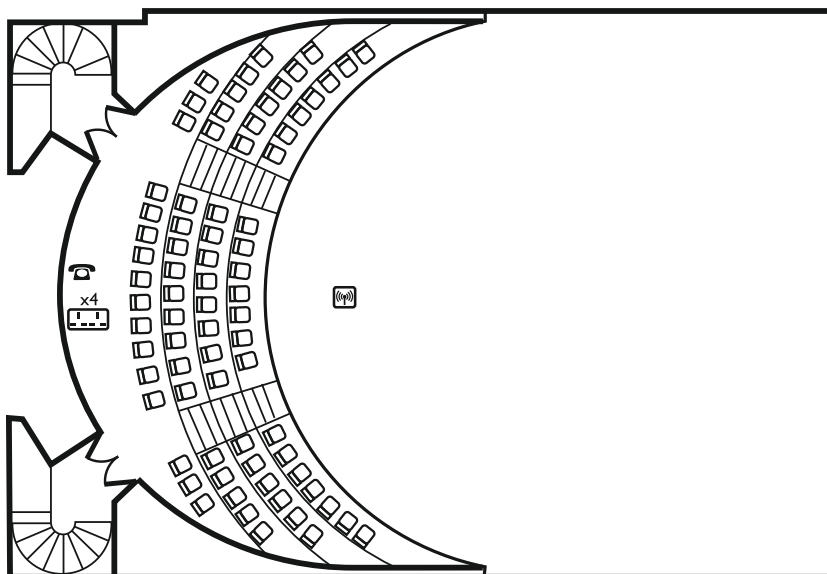















SECOND FLOOR GREAT HALL

SAVILL COURT

HOTEL & SPA - NR WINDSOR

KEY

-  DOUBLE POWER SOCKET
-  SINGLE POWER SOCKET
-  TV AERIAL SOCKET
-  ISDN SOCKET
-  SMART BOARD
-  TELEPHONE SOCKET
-  MOVEABLE PARTITION
-  VIDEO SCREEN
-  TEMP/AIRCON CONTROL
-  PA SYSTEM SOCKET
-  LIGHT SWITCH/DIMMER
-  ADSL SOCKET
-  FAX SOCKET
-  WIRELESS BROADBAND

BOARDROOM 2

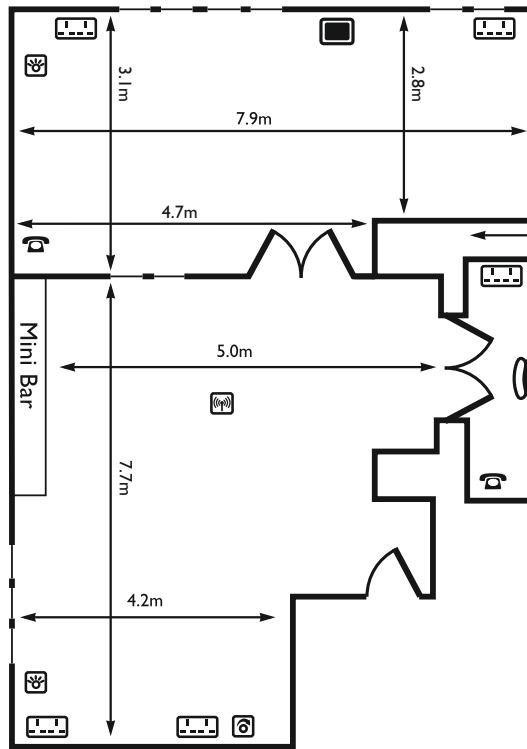

BOARDROOM I

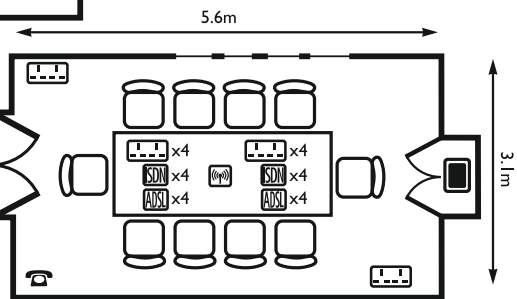

EXECUTIVE LOUNGE

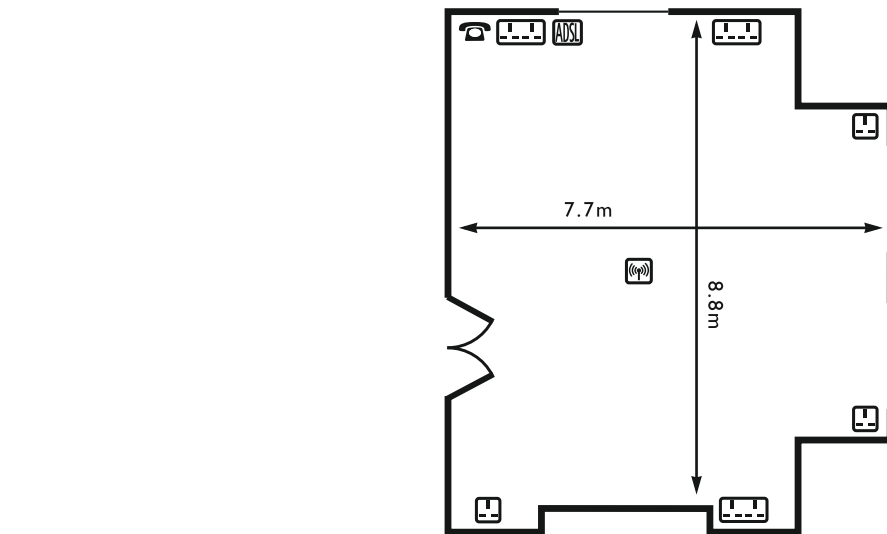

LIBRARY

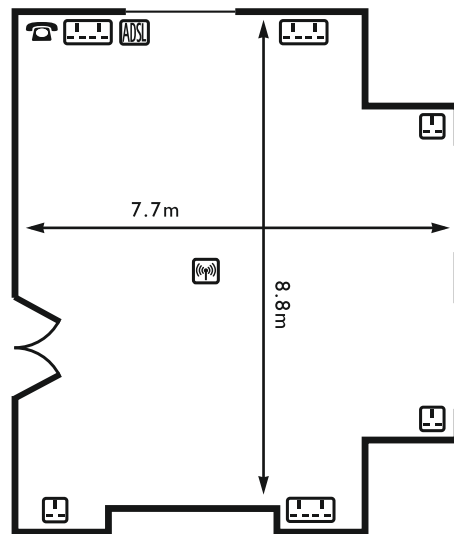

SAVILL COURT

HOTEL & SPA - NR WINDSOR

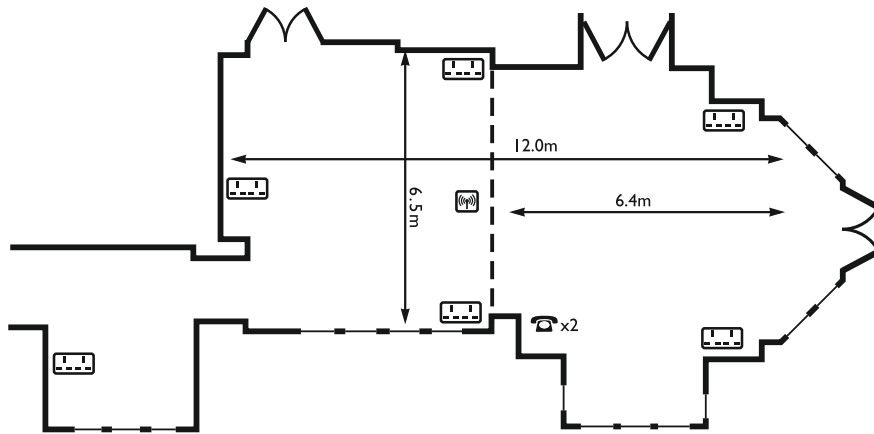



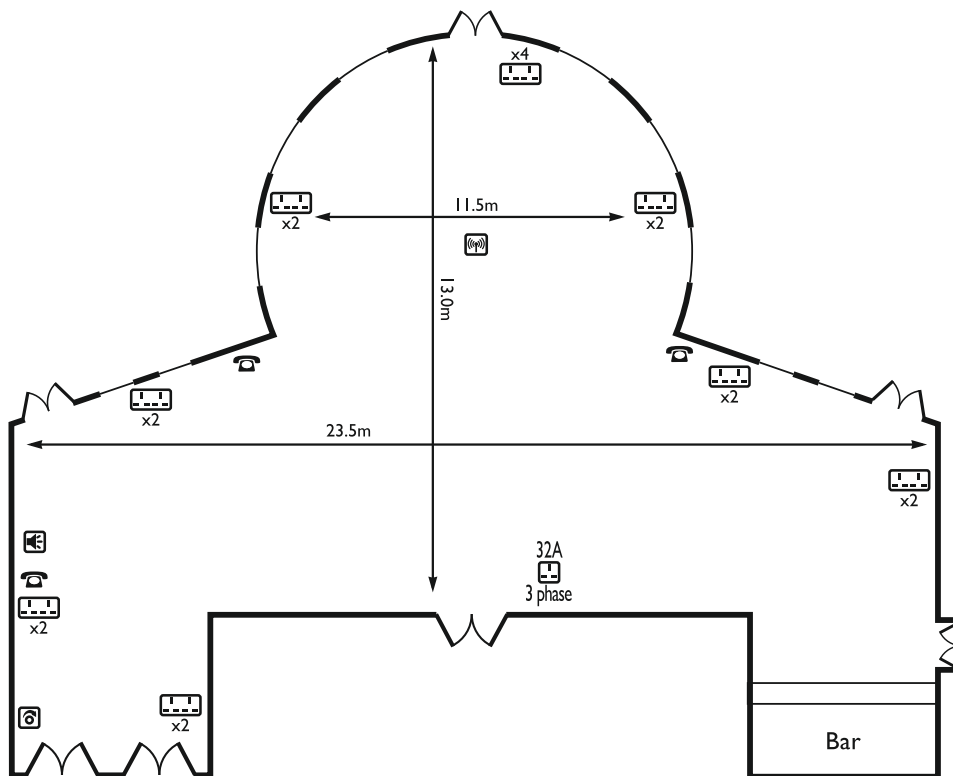









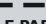

TERRACE ROOM



THE ORANGERY

KEY

-  DOUBLE POWER SOCKET
-  SINGLE POWER SOCKET
-  TV AERIAL SOCKET
-  ISDN SOCKET
-  SMART BOARD
-  TELEPHONE SOCKET
-  MOVEABLE PARTITION
-  VIDEO SCREEN
-  TEMP/AIRCON CONTROL
-  PA SYSTEM SOCKET
-  LIGHT SWITCH/DIMMER
-  ADSL SOCKET
-  FAX SOCKET
-  WIRELESS BROADBAND

MIDLANDS & THE SOUTH